

HUSH SUSPENDED CEILINGS



Hush Metal Frame Ceiling System is an accepted method of creating a decoupled acoustic ceiling below a joisted or concrete structure. This is one of the best ways to provide acoustic attenuation where the installation of a lowered ceiling is not a problem. Also allows for service voids to be created at ceiling level.

ACOUSTIC PERFORMANCE

Impact $L'_{nT,w}$ dB	Airborne $D_{nT,w}$ dB	Airborne $D_{nT,w} + C_{tr}$ dB
51	56	52

Results based on Hush-System LC HD1036 which incorporates a suspended metal ceiling



PRODUCT DATA

- Comprises metal grid system with acoustic hangers.
- A minimum void of 150mm should be left from the underside of the joists to the back of the plasterboard lining.

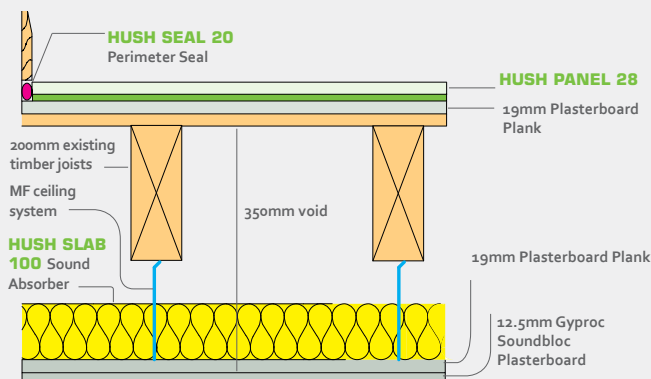

SUITABLE FOR:



FEATURES

- ✓ Excellent acoustic performance
- ✓ Refurbishment and New Build
- ✓ Can be suitable for suspending up to 70 kg/m² if components are used at the correct centres
- ✓ Building Regulations Part E (England and Wales), Section 5 (Scotland) and Part G (Northern Ireland)
- ✓ Easy to install
- ✓ Can be used as part of a Code For Sustainable Homes specification
- ✓ Can be used as a ceiling treatment within Robust Details specifications
- ✓ Can create a service void at ceiling level
- ✓ Economical ceiling solution

HUSH ACOUSTICS

TEL: 0151 933 2026

EMAIL: info@hushacoustics.co.uk

www.hushacoustics.co.uk

[hush-acoustics](https://www.linkedin.com/company/hush-acoustics)

[@hushacoustics](https://twitter.com/hushacoustics) [hushuk.acoustics](https://www.facebook.com/hushuk.acoustics)

44 Canal Street, Bootle, Liverpool L20 8QU
Offices also based in London and Yorkshire



HUSH ACOUSTICS